

Meet the WILCO Family of Equipment for the Wire Drawing Industry

WIRE LAB COMPANY

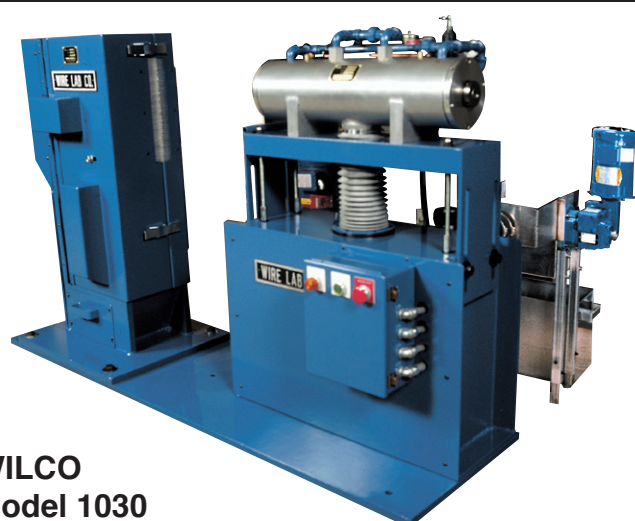

**WILCO
Model 920**
Air Jet Descaling System



**WILCO
Model 1030**
Water Jet Descaling System



**WILCO
Model 1060**
Mechanical Descaling System with Precoating



**WILCO
Model 1250**
Automatic Brush Descaling System



**WILCO
Model 1750**
Automatic Brush Descaling System with Precoating



**WILCO
Model 200/200-S**
Scale Collectors

WILCO Lubricant Applicators



Model LA-S
Designed for wire diameters
from 1/32 to 7/32 inch
(.8 to 5.5mm)

Model LA-CW
Designed for wire diameters
from 1/8 to 5/8 inch
(3.2 to 15.9mm)

WILCO Lubricant Applicators

Maximize Lubrication

WILCO Lubricant Applicators are a wire drawing aid designed to apply more lubricant on the rod or wire surface. More lubricant assures smoother, more efficient wire drawing operations.

Primarily for use with dry powdered soap lubricants, WILCO Lubricant Applicators are also useful with high viscosity lubricants, such as light greases and oils.

WILCO Lubricant Applicators can be used in each die box of multi-draft machines but are especially effective when used in the first draft to establish maximum lubrication. WILCO Lubricant Applicators are the only production tool available that adds lubricant to the drawn wire surface after the ripper draft.

For All Types of Wire WILCO Lubricant Applicators are designed for use in all types of wire drawing operations and are used throughout the wire drawing industry. Some of the materials processed using WILCO Lubricant Applicators —

Steel	Alloy Steel	Composites
Low thru	Stainless Steel	Titanium
High Carbon	High Nickel Alloys	Aluminum

WILCO Lubricant Applicators are especially recommended in drawing mechanically descaled wire rods — in fact, they are the best approach to compensate for the lack of carrier coating on mechanically descaled rods.

A Choice of Models Two models of WILCO Lubricant Applicators are designed for a full range of rod and wire sizes from 1/32 inch (0.8mm) to 5/8 inch (15.9mm) diameter. Special modified Lubricant Applicators to accommodate extra fine wire or larger rod diameters up to 31mm are also available.

Model LA-S
1/32 to 7/32 inch diameter
(0.8mm to 5.5 mm)

Model LA-CW
1/8 to 5/8 inch diameter
(3.2 to 15.9 mm)

At 4 inches wide by 5 inches long (101mm x 127mm), the LA-CW is designed to fit in most ripper boxes. The LA-S is 2-1/2 inches wide by 3-1/4 inches long (63.5mm x 82.5mm) and intended for intermediate boxes or very small ripper boxes.

Easy to Install

The caliper-type design of WILCO Lubricant Applicators allows quick, “snap-on” installation in the lubricant box.

THERE IS NO NEED FOR
THREADING.

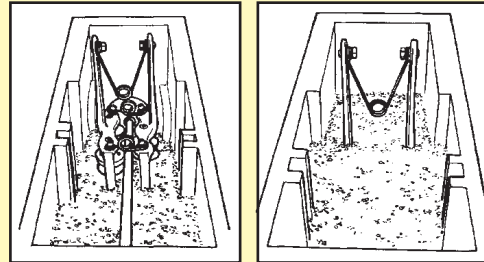

Important Benefits

WILCO Lubricant Applicators are used throughout the wire drawing industry to:

Solve wire drawing problems such as:

- Die Scratching
- Low Die Life
- Wire Breaks

Increase wire productivity through:

- Higher Draw Speeds
- Extended Die Life

Improve wire quality with:

- More Uniform Surface Finish

Replacement Parts Parts eventually requiring replacement are available on a same-day basis from a full parts inventory (see parts list).

PARTS LIST MODEL LA-S

PART NUMBER	DESCRIPTION	NUMBER REQUIRED PER UNIT
AA	DOUBLE ROLL FRAME	1
BB	SINGLE ROLL FRAME	1
* DD	CAP SCREW	4
* EE	LOCK WASHER	6
* FF	FLAT WASHER	6
GG	PIVOT SCREW	6
HH	ROLL SUPPORT	6
JJ	COMPRESSION SPRING	3
KK	ROLL (PLAIN)	3
KK	ROLL (KNURLED)**	3
MM	HANDLE SPRING	1
NN	FRAME SPRING	2
* QQ	BUTTON HEAD CAP SCREW	2
* RR	HEX NUT	2
SS	FASTENER PACKAGE	1

Consists of:
4-Cap Screws 2-Button Head
6-Lock Washers Cap Screws
6-Flat Washers 2-Hex Nuts

* Available only as part SS
** Optional

PARTS LIST MODEL LA-CW

PART NUMBER	DESCRIPTION	NUMBER REQUIRED PER UNIT
A	DOUBLE ROLL FRAME	1
B	SINGLE ROLL FRAME	1
* D	CAP SCREW	4
* E	LOCK WASHER	6
* F	FLAT WASHER	6
G	PIVOT SCREW	6
H	ROLL SUPPORT	6
J	COMPRESSION SPRING	3
K	ROLL (PLAIN)	3
K	ROLL (KNURLED)**	3
M	HANDLE SPRING	1
N	FRAME SPRING	2
* Q	SET SCREW	6
* R	BUTTON HEAD CAP SCREW	2
* S	HEX NUT	2
T	FASTENER PACKAGE	1

Consists of:
4-Cap Screws 2-Button Head Cap Screws
6-Lock Washers 2-Hex Nuts
6-Flat Washers 6-Set Screws

* Available only as part T
** Optional

PARTS LIST – MODEL LA-S

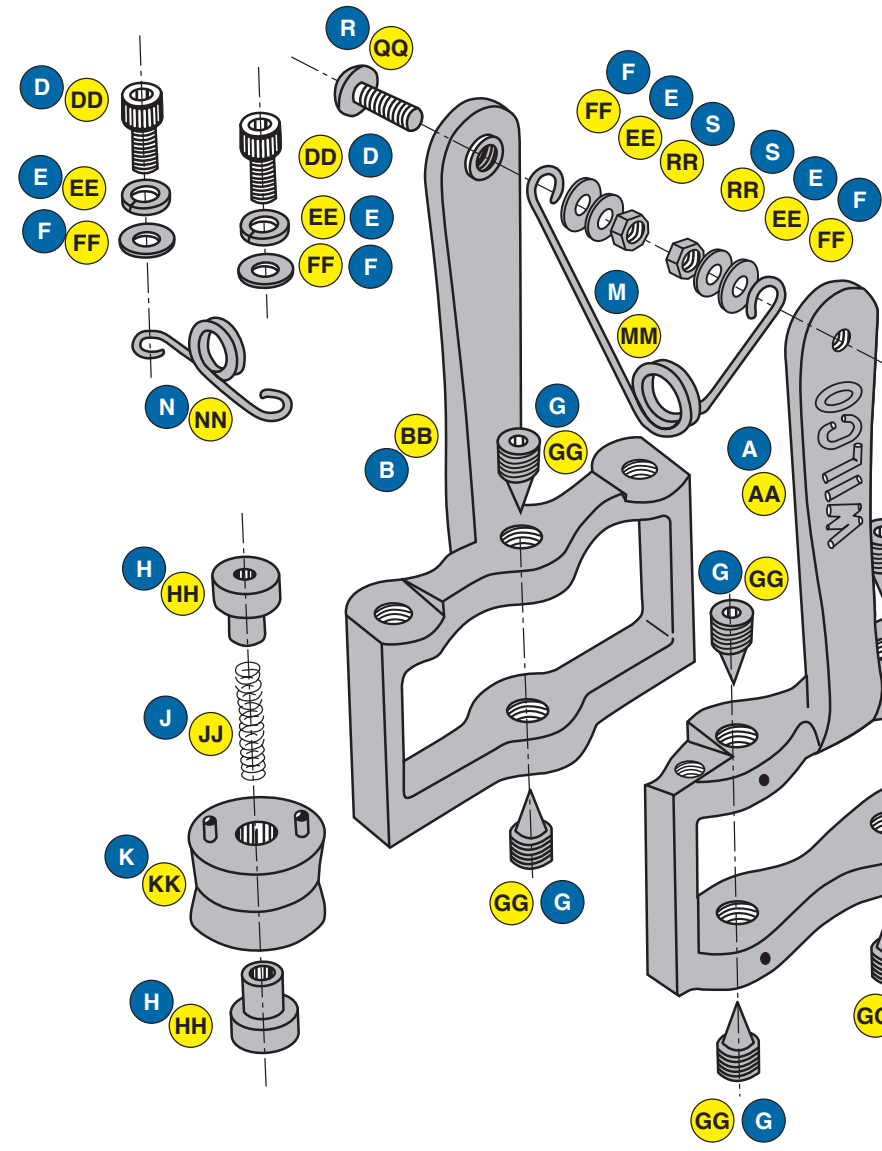

MODEL LA-CW

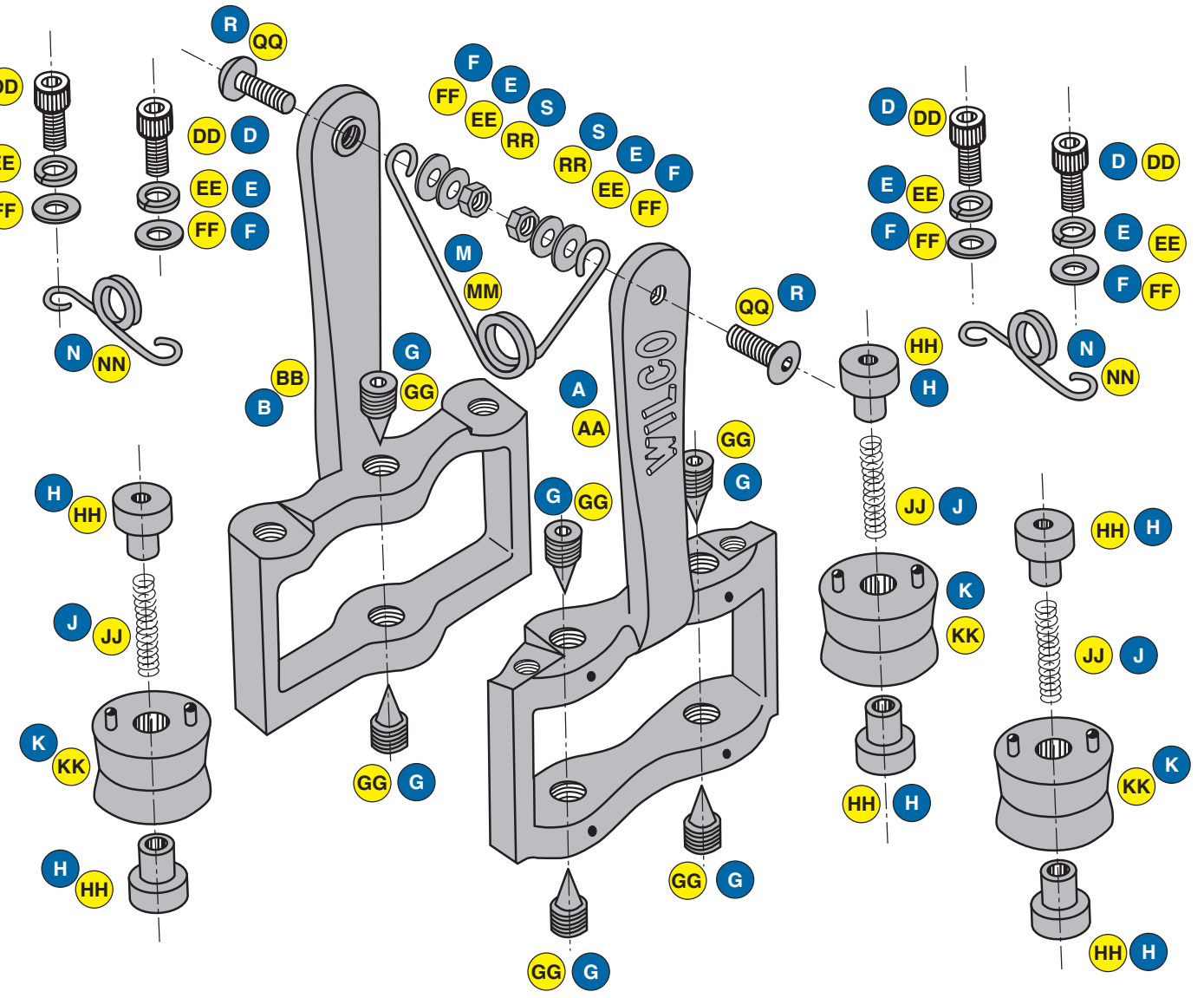

MODEL LA-CW

Pivot screws, on model LA-CW, are locked in place with set screws, Part Q

